

# ALUMINUM SPLIT BOLT CONNECTORS

## • TYPE SWA

For aluminum to aluminum, copper to aluminum,  
and copper to copper



AL 9CU  
UL486B

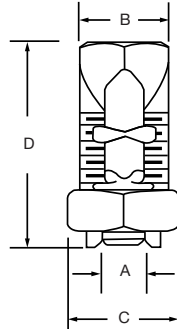

Made from high strength, heat treated aluminum alloy—highly resistant to corrosion. The design provides, under torque, high contact pressure between conductors.

Electro tin-plated bolt, nut, spacer and pressure bar.

Meets and exceeds requirements of the UL486B standard.

There is no need to scratch brush or use oxide inhibiting compounds for installation of 90°C max rated conductors in NEC applications. For all other applications, the use of Penn-Union Cual-Aid® #11C, oxide inhibiting compound, is recommended.

Part #	Range of Equal Main & Tap (Copper and Aluminum)	Wire Diameter Range‡ (in inches)	Approximate Dimensions (In Inches)				Recommended Torque (in.-lb.)
			A	B	C	D	
SWA7	6 Sol. - 1/0 Str.	.162-.375	.375	.750	1.00	1.81	385
SWA8	2 Sol. - 2/0 Str.	.257-.418	.419	.88	1.12	2.12	390
SWA10	1/0 Str. - 250 MCM	.368-.575	.582	1.19	1.50	2.63	650
SWA11	2/0 Str. - 350 MCM	.414-.681	.746	1.31	1.63	2.91	650
SWA12	3/0 Str. - 500 MCM	.464-.814	.834	1.44	1.81	3.28	825

‡ For conversion to metric range, see page F-65.