

COPPER SOLDERLESS LUGS • TYPES SLU & SAU

One hole, single collar

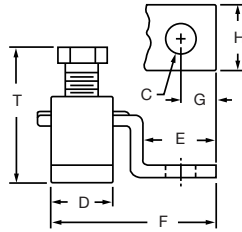
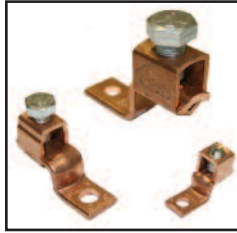

100% pure electrolytic copper for utmost efficiency.

Unique design of the concave pressure bar and V-bottom collar assures positive contact and firm, permanent grip.

Part #	Conductor Range (Copper Stranded)	Approximate Dimensions														Ampere Rating NEC
		C		D		E		F		G		H		T		
		in	mm	in	mm	in	mm	in	mm	in	mm	in	mm	in	mm	
SLU25	10, 12, 14	5/32	3.96	9/32	7.14	15/32	5.55	15/16	25.40	3/16	4.76	5/16	7.93	2 1/32	16.66	25
SLU35	6, 8, 10, 12, 14	13/64	5.15	7/16	11.11	3/8	12.70	1 1/16	30.16	7/32	5.55	3/8	9.52	3/4	19.05	35-50
SAU70	4, 6, 8, 10, 12, 14	17/64	6.74	7/16	11.11	17/32	13.49	1 1/4	33.33	1/4	6.35	1/2	12.70	13/16	20.63	70
SLU70	2, 4, 6, 8	17/64	6.74	1/2	12.70	1 1/16	18.25	1 7/16	38.89	1/4	6.35	1/2	12.70	1	25.40	70-90
SLU125	1/0, 1, 2, 4, 6, 8	17/64	6.74	5/8	15.87	7/8	20.63	1 7/8	50.00	7/16	11.11	5/8	15.87	1 11/32	34.13	125
SLU175	3/0, 2/0, 1/0, 1, 2, 4	13/32	10.31	3/4	19.05	1 1/32	26.19	2 1/4	53.97	7/16	11.11	3/4	19.05	1 9/16	39.68	175
SLU225	4/0, 3/0, 2/0, 1/0, 1, 2	11/32	8.73	1	25.40	1 3/32	29.36	2 3/8	66.67	15/32	12.70	1	25.40	1 13/16	46.03	225
SLU300	350 MCM, 300 MCM, 250 MCM, 200 MCM, 4/0, 3/0, 2/0, 1/0	13/32	10.31	1 1/4	31.75	1 9/16	38.10	3 7/32	80.96	1/2	12.70	1	25.40	2 5/8	66.67	300
SLU400	500 MCM, 400 MCM, 350 MCM, 300 MCM, 250 MCM, 4/0	13/32	10.31	1 1/2	38.10	1 7/8	49.21	4 1/16	107.95	29/32	23.81	1 1/2	38.10	2 3/4	69.85	400
SLU650	1000 MCM, 900 MCM, 800 MCM, 750 MCM, 700 MCM, 600 MCM	17/32	13.49	1 7/8	47.62	2 1/8	47.62	4 5/8	117.47	1 1/16	30.16	2	50.80	3 11/16	93.66	650



MULTIPLE SOLDERLESS LUG • TYPE LU

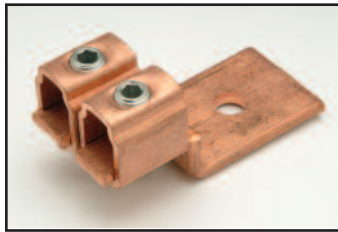

Made from electrolytic copper for utmost efficiency. Screws are cadmium plated steel. Unique design of the concave pressure bar and V-bottom collar assures positive contact and firm, permanent grip.

Part #	Conductor Range (Copper Stranded)	Ampere Rating NEC
LU2	2 No. 4/0, 2 No. 3/0, 2 No. 2/0	400
LU4	2 No. 350 MCM, 2 No. 300 MCM, 2 No. 250 MCM 2 No. 4/0, 2 No. 200 MCM, 2 No. 3/0, 2 No. 2/0, 2 No. 1/0	600
LU6	2 No. 500 MCM, 2 No. 400 MCM, 2 No. 350 MCM 2 No. 300 MCM, 2 No. 250 MCM, 2 No. 4/0	800