

Product: \_\_\_\_\_

Type: \_\_\_\_\_

Project: \_\_\_\_\_

**In-Ground  
Rock Guard Cover**  
Natural Metal  
Composite Black



**Fixture Ordering Guide**

Product Code	Finish
IGG049	AB - Antique Brass
	BR - Brass
	CB - Composite Black
	SS - Stainless Steel

Order Lamp Separately  
Example: IGG049-AB-MR16BAB/827/LED

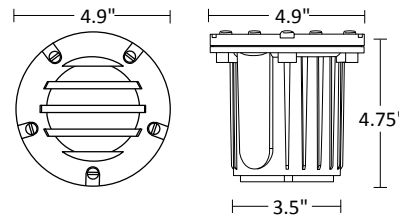

**Housing:**

- Single-piece compression molded fiberglass reinforced polyester composite
- Silicone o-ring provides a watertight seal

**Cover:**

- Antique Brass, Brass, Composite Black or Stainless Steel

**Lens:**

- Shock and heat-resistant clear, tempered glass

**Socket:**

- Ceramic GU5.3 bi-pin socket
- Stainless steel retention clip ensures secure lamp seating and protects the lamp from shock and vibration
- Heat-resistant wire leads

**Lamp:**

- MR16 – 57W maximum
- ProLED® MR16 lamps offer 40,000 hour rated life, 10-15V input voltage range, multiple beam spreads (flood, narrow flood, spot and wide flood) and 2700K, amber, blue, green, red and color changing options

**Electrical:**

- 12 Volt system
- Pre-wired with 36", 18-2 lead wire
- Two King® DryConn™ waterproof connectors included

**Certifications:**

- ETL Listed to UL Standard 1838 and CSA C22.2 No. 250.7

**Fasteners:**

- All fasteners are corrosion-resistant stainless steel

**Warranty:**

- Backed by a lifetime (Brass and Stainless Steel) or 10-year (Composite) limited warranty to be free from defects in material and/or workmanship
- ProLED® MR16 lamps installed in Sollos fixtures per installation instructions are backed by a 20-year limited warranty

**Photometrics:**

