

Product: _____

Type: _____

Project: _____

BSB067 Straight Bullet

Natural Metal

Fixture Ordering Guide

Product Code	Finish
BSB067	AB - Antique Brass
	CU - Copper
	SS - Stainless Steel

Order Lamp Separately

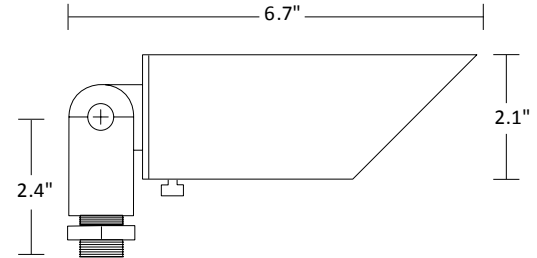

Shroud:

- Antique Brass, Copper or Stainless Steel
- Copper ages gracefully as patina develops
- Antique Brass finish is natural brass with an electrostatic coating that is hand polished and rubbed for an elegant aged brass appearance
- Brass slotted thumb screw for easy, tool-free lamp replacement

Housing:

- Cast brass base and knuckle
- Fully adjustable swivel arm with locking teeth maintains desired angles
- Two silicone o-rings provide a low-friction, watertight seal
- Gasketed knuckle to prevent water intrusion

Lens:

- Shock and heat-resistant clear, tempered glass

Socket:

- Ceramic GU5.3 bi-pin socket
- Stainless steel retention clip ensures secure lamp seating and protects the lamp from shock and vibration
- Heat-resistant wire leads

Lamp:

- MR16 – 50W maximum

Mounting:

- 8" black ground stake included

Electrical:

- 12 Volt system
- Pre-wired with 36", 18-2 lead wire
- Two King® DryConn™ waterproof connectors included

Certifications:

- ETL Listed to UL Standard 1838 and CSA C22.2 No. 250.7

Fasteners:

- All fasteners are corrosion-resistant stainless steel

Warranty:

- Backed by a lifetime (Antique Brass, Brass and Stainless Steel) or 15-year (Copper) limited warranty to be free from defects in material and/or workmanship
- ProLED® MR16 lamps installed in Sollos fixtures per installation instructions are backed by a 20-year limited warranty

Photometrics:

