

# 2" INGROUND

2081

# WAC

## LANDSCAPE LIGHTING

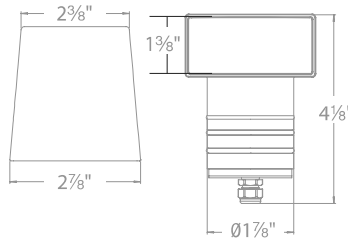

### PRODUCT DESCRIPTION

Landscape 2" recessed in-ground luminaire washes walkways with a smooth illumination.

### FEATURES

- Factory sealed water tight fixtures
- Cold Weather Start: -40°C to 50°C
- Solid stainless steel construction
- Available Concrete Pour Adapter
- Spring clip, 6' lead wire and direct burial gel filled wire nuts included

### SPECIFICATIONS

**Input:** 9 - 15VAC (Transformer is required)  
**Power:** 4.1W / 6.6VA  
**Brightness:** 35 lm  
**CRI:** 85  
**Rated Life:** 70,000 hours

### ORDERING NUMBER

		Color Temp	Finish
<b>2081</b>	<i>Scoop</i>	<b>30</b> 3000K	<b>BS</b> <i>Bronzed Stainless Steel</i> <b>SS</b> <i>Stainless Steel</i>

**2081-30** \_\_\_\_\_

Example: **2081-30SS**

wacighting.com  
Phone (800) 526.2588  
Fax (800) 526.2585

Headquarters/Eastern Distribution Center  
44 Harbor Park Drive  
Port Washington, NY 11050

Central Distribution Center  
1600 Distribution Ct  
Lithia Springs, GA 30122

Western Distribution Center  
1750 Archibald Avenue  
Ontario, CA 91760

# 2" INGROUND

2081

# WAC

## LANDSCAPE LIGHTING

### Magnetic Transformers



*Stainless Steel, 12-15V output,  
IP65 rated, UL 1838 listed  
See transformer spec sheet for  
details and its accessories*

**9075-TRN-SS**  
75W Max

**9150-TRN-SS**  
150W Max

**9300-TRN-SS**  
300W Max

**9600-TRN-SS**  
600W Max

### 2" Concrete Pour Kit

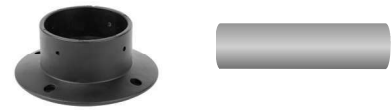

*For installation in concrete.  
Use with a 4" outdoor rated junction box  
and a trade size 2" schedule 80 PVC pipe*

**2000-CON-PVC**

### TESTED MAGNETIC LOW VOLTAGE (MLV) DIMMERS

Luminaire	Dimmer					
	Manufacturer	Family	Model	Power Rating	Range*	Note
<b>2081</b>	Lutron	Diva	DVLV-600	600W	20% - 100%	
		Skylark	SLV-600P	600W	15% - 100%	Best performance
		Skylark	S-10P	1000W		Not recommended

\*Low end of this range is determined by output current which may not directly translate to the perceived light output

WAC Lighting fixtures are compatible with a variety of dimmers. For your convenience we have included a compatibility chart showing dimmers which have been tested with our products. The recommended list below is based upon testing conducted in a lab, and the results can vary in certain field applications due to a number of factors. Exclusion from the list does not imply incompatibility, just that it has not been tested by WAC Lighting. Please reference the dimmer manufacturer's instructions for installation, or contact a WAC Lighting professional at 800-526-2588.

wacighting.com

Phone (800) 526.2588

Fax (800) 526.2585

Headquarters/Eastern Distribution Center

44 Harbor Park Drive

Port Washington, NY 11050

Central Distribution Center

1600 Distribution Ct

Lithia Springs, GA 30122

Western Distribution Center

1750 Archibald Avenue

Ontario, CA 91760