

OUTDOOR
AREA LIGHTING

Parking Lot Lighting Solution



natural^{led}[®]



Slim Area Light



At naturaLED®, we understand the role that parking lot lighting plays when it comes to safety and saving money on energy bills. We designed our Slim Area Light to meet the demand for parking lot lights that are highly functional, environmentally sustainable and energy efficient. Not only does this light meet those needs, but it also delivers 130 lumens per watt with a whole fixture heat dissipating thermal housing and modular component system.

Our naturaLED® Slim Area Light is constructed with a durable, die-cast aluminum housing and excellent thermal design. It provides uniformed consistent color with a wide range of wattage selections and voltages to replace HID Fixtures from 50W to 1500W for higher efficiency, making this the ideal solution for your parking lot lighting needs.

With over 15 years of innovative experience, naturaLED® is a leading manufacturer in the LED lighting industry. Based in the U.S. with warehouses in California and North Carolina, we are located to serve our customers quickly and efficiently. We are confident the benefits found by transitioning to LED parking lot lighting is guaranteed to exceed your expectations. Saving both time and money from maintenance and energy expenses while increasing lifetime performance, you can trust that naturaLED® delivers value and support you can depend on.

Trust. Value. Support.



DESIGNED TO LAST

Durable Performance ●



Durable
Heat Resistant
Ceramic
Cree LED Chips

12KV Surge
Protection

High Impact
Protective Lens
IK08

Custom, High
Industrialized
Driver

Aluminum
Die-Cast
Thermal Housing

Wide Range Operating
Temperature



Thermal Design Housing

With excellent thermal management, our fixture allows operating temperatures of -40°F ~ 122°F while still maintaining lumen throughout lifespan.

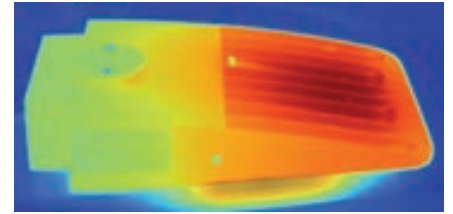
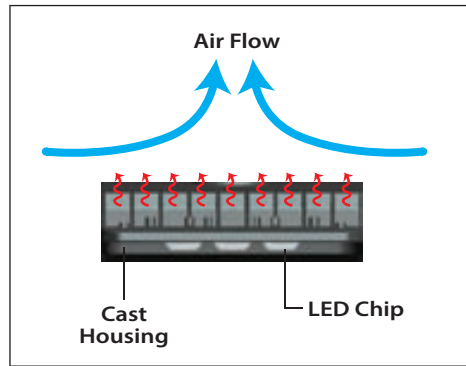

Pictured above: Our thermal design of heat sink contained at the front of the fixture, allows more surface air flow for heat dissipation. Better maintained thermal performance and lower junction temperature means longer life and higher delivered lumen output.

Why Thermal Management Matters

LEDs generate heat, but unlike traditional light sources they transmit heat instead of radiating it. This means most of the heat from an LED goes upward into the fixture housing. This heat, coupled with heat generated by the power supply, must somehow exit the system through conduction, convection or a combination of both. Since LEDs are sensitive to heat they must be kept below their rated maximum temperature. Consequently, luminaire manufacturers need to be conscious of these heat dissipation challenges in order to design effective thermal management systems that support LED performance and longevity. Inadequate thermal management can lead to a shift in color, lower light output, and dramatically shortened life. However, thermal management involves more than just evacuating heat from the fixture; it includes using the best LEDs and being able to operate at a low drive-current while still providing high lumens per watt. A lower drive-current means less heat, which allows the fixture to manage heat better.

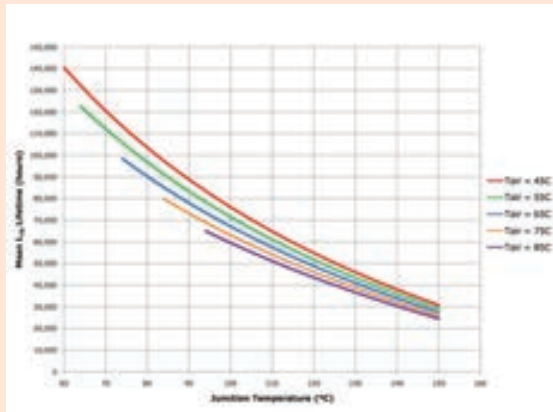

Ceramic Chips

Heat resistant ceramic Cree LED chips are used for high temperature operations, offer long lasting, increased performance. Our new 4-LED chip design within each optic lens, allows for even heat distribution throughout the board, increasing LED life and high lumen maintenance.

IK08

Excellent protection against mechanical impacts 

IP65

Dust tight and waterproof



Dust tight, no ingress of dust



Protected against water projected from a nozzle



Light Distribution Types

Type III lens

Type III distribution is meant for general parking lots and other locations where a larger area of lighting is required.

Type IV lens

Type IV distribution produces a semicircular light meant for mounting on the sides of buildings and walls. It's best for illuminating the perimeter of parking areas and businesses.

Type V lens

Type V produces a circular distribution that has the same intensity at all angles. This distribution has a circular symmetry of candlepower that is essentially the same at all lateral angles. It is meant for large, commercial parking lot lighting as well as areas where sufficient, evenly distributed light is necessary.



Type III



Type IV



Type V

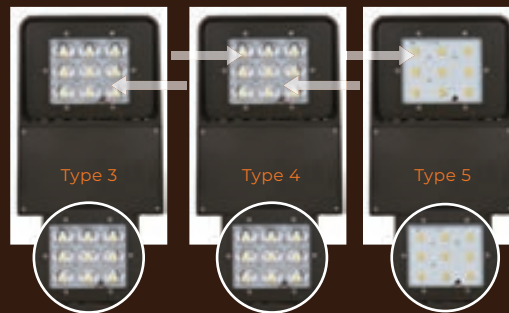

Optical Control

Specifically designed for Type III, Type IV and Type V light distribution. Our interchangeable settings allow architects, designers, business owners, and consumers to create lighting layouts without any restraints.

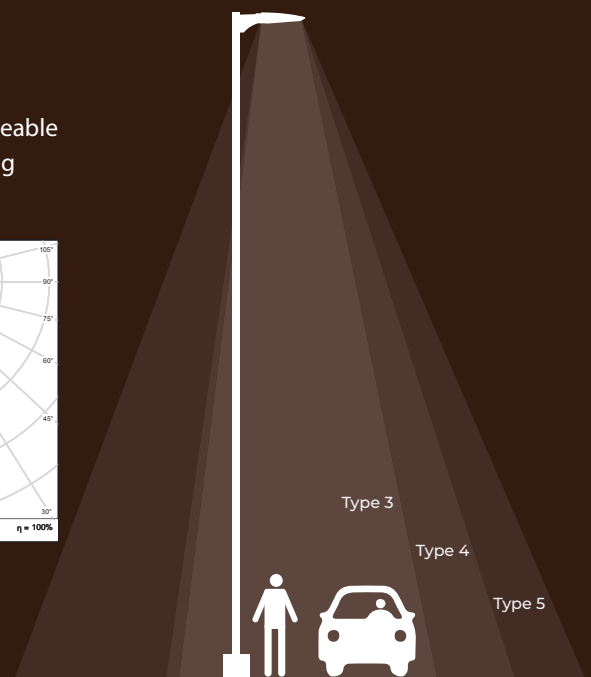
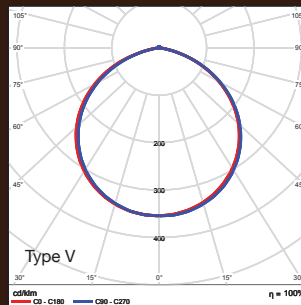
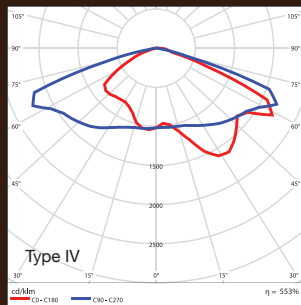
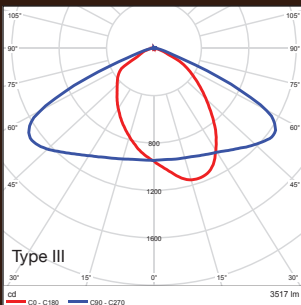

Accessories SENSOR

Motion Sensor

Whether you are looking to illuminate your parking structure or outdoor parking lot, motion sensor lighting is a must when it comes to the security and safety of your property at night. Movement triggers the motion sensor allowing the lights to automatically turn on, so they work best in areas that do not require continuous illumination.



Remote Sensor Control

Giving you total control of each fixture, our Slim Area Light has the option of an occupancy sensor and remote control. Set your preferred setting for lighting into the remote then simply point it at the occupancy sensor and watch the fixture follow your command.

Photocell Sensor

Photocell sensors detect light, saving energy costs by controlling your on/off settings from dusk to dawn.



Choice of
3 pin / 5 pin / 7 pin

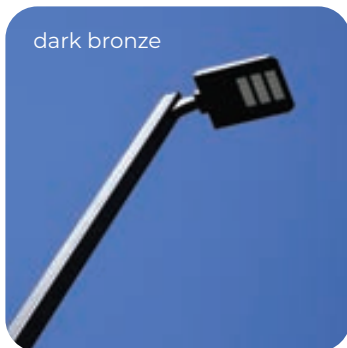

dark bronze



white

Color Choices

Dark bronze and white are our standard finishes. Different color choices are available as special order.



Black



Grey



The glare shield produces superior vertical illuminance and efficiently directs the light without wasteful and unwelcomed light spill into neighboring properties. Because of variation of parking lot configurations, this front or back shielding can accommodate challenging sites.

100W SAL

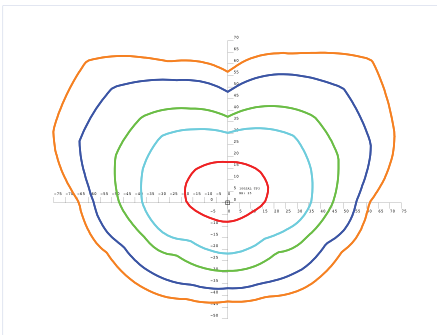

100W SAL with Back Shield

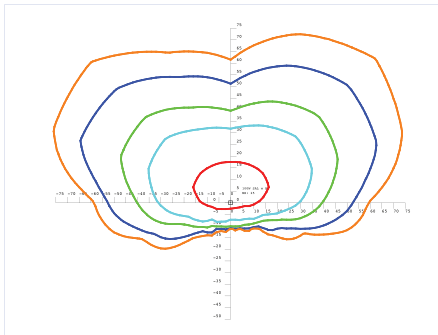

100W SAL with Front Shield

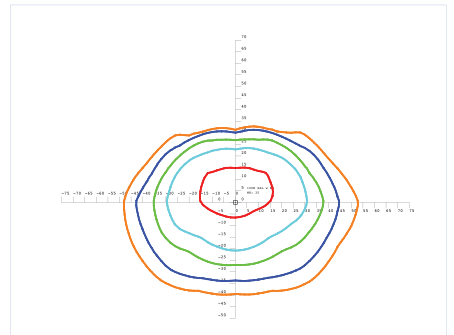

Accessories

GLARE SHIELD

Mounting Options



The Slim Area Light comes in 6 mounting options: Swivel Bracket, Slip Fitter, Yoke, 6" Extruded Arm, Wall Mount and Pendant Mount. All fixtures are DLC premium certified with superior LED performance in distribution, color, and longevity/stress along with an IP65 rating, which makes the thermal housing dust proof and water resistant. This highly efficient LED helps illuminate the environment for years while maintaining uniformity and consistent color.

6 Mounting Options



Swivel Bracket



Wall Mount



Pendant Mount
(rigid pole not included)



6" Extended Arm



Yoke Mount



Slip Fitter

2 Dimensions

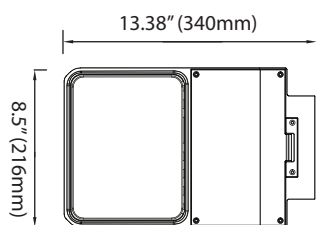

model: 29W 50W 75W 100W

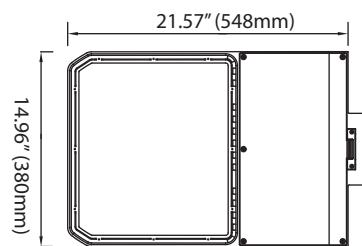
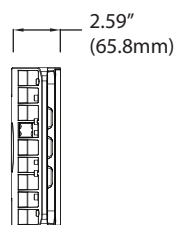

model: 150W 180W 240W 360W

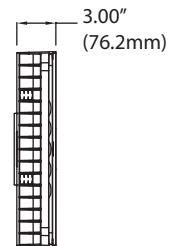

Pole Mounting Configurations

Created with an innovative sleek design in mind, our "Slim Area Light" provides wide-ranging mounting configurations. Allowing for up to 4 lights on the pole, they provide complete coverage for any site.



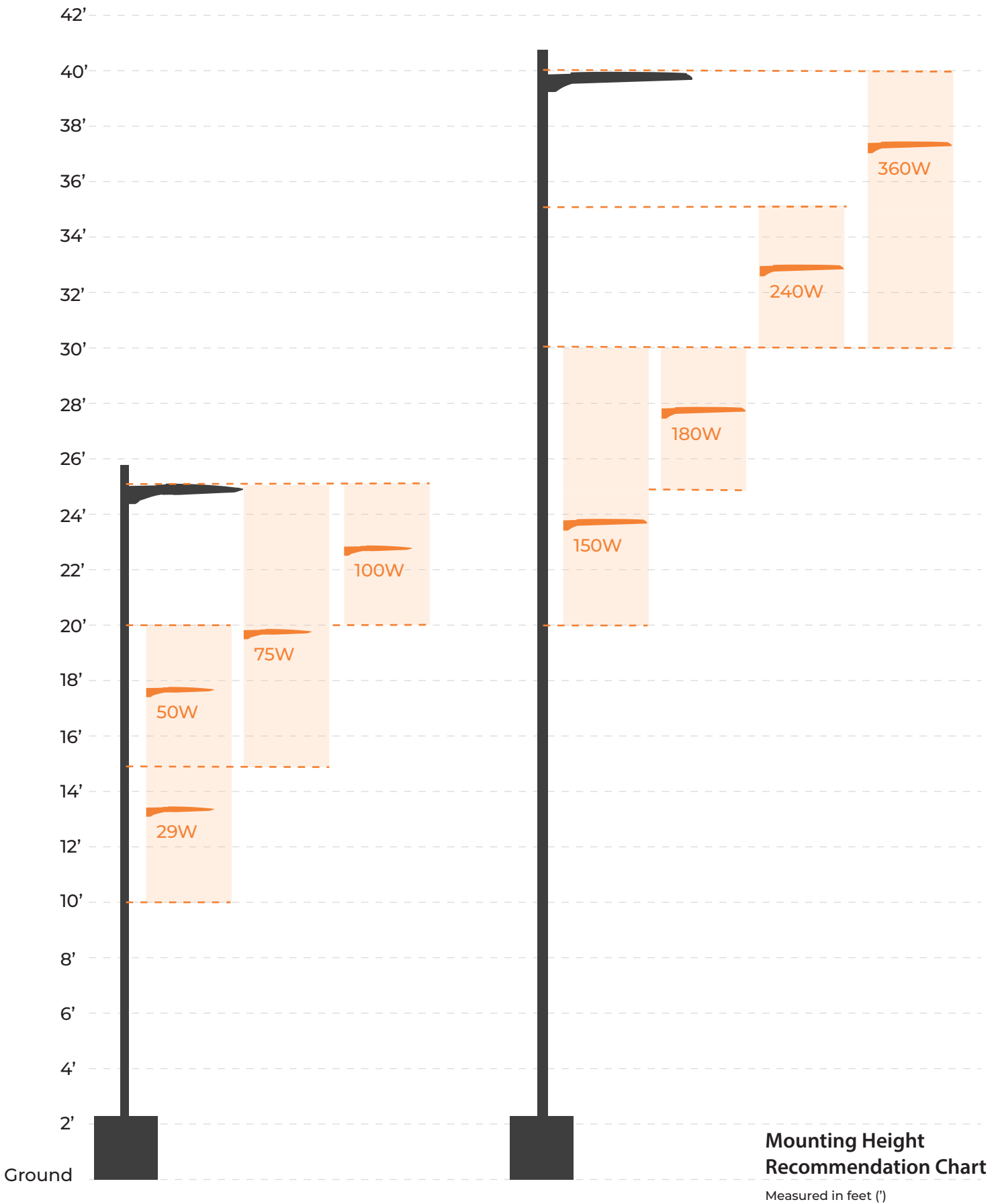

BUILT
TO
LAST





natura**led**[®]

Turning Lights into Savings



California, USA

2000 S. Grove Ave, Bldg B, Ontario, CA 91761
855-758-7009 | 909-930-6868

Texas, USA

11011 Regency Crest Dr. Ste 800, Dallas, TX 75238

North Carolina, USA

2511 Reliance Ave, Apex, NC 27539

Canada

5514-275th Street, Langley, BC V4W 3X7